

# HDMI TO RCA+ S-VIDEO

## USER Manual

### 1.0 Introduction

The HDMI to CVBS+S-Video converter converts HDMI signal to CVBS/S\_VIDEO video signal and the FL/FR stereo audio signals. It helps user convert the high quality of the HDMI video signal into normal CVBS and S\_VIDEO signal (standard-definition 480i,576i), which will enable it to play on TV, VHS VCR, DVD recorders, etc, support PAL\_B/N/M, NTSC\_M/J/Nc output.

### 1.1 Features

1. No need to install drivers, portable & flexible, just plug and play.

2. Low power via USB cable, no power adaptor.

**Notice:** When the converter is connected with some devices (such as Sony Blu-ray DVD, XBOX360, PS4 and so on) which can not supply enough power from HDMI port, the converter need extra power supply via the USB cable.

3. Compatible with HDMI1.3.

### 2.0 Specification

1. Input ports: 1xHDMI.

2. Output ports: 1xCVBS(Yellow);  
1xL(White);  
1xR(Red);  
1xS-VIDEO

3. Dimensions(mm): 110(D)x84(W)x28(H)

4. Weight(g): 63g

5. HDMI Input Resolution: 640x480@60Hz, 800x600@60Hz, 1024x768@60Hz, 1280x720@60Hz, 1280x1024@60Hz, 1360x768@60Hz, 480p60Hz, 576i50Hz, 720p50/60Hz, 1080i50/60Hz, 1080p50/60Hz.

6. CVBS output : PAL\_B/N/M NTSC\_M/J/Nc

7. S-VIDEO output: PAL\_B/N/M NTSC\_M/J/Nc

8. MODE key: If you press the key, the output video mode will be changed.

### 3.0 Package Contains

Before using this unit, please check the packing and make sure the following items are contained in the shipping carton:

- 1) Main unit(HDMI to RCA+S-Video)-----1PCS
- 2) Micro USB cable-----1PCS
- 3) User Manual-----1PCS

~ 2 ~

~ 3 ~

### 4.0 Graphics decomposition

Please read the graphics decomposition below and be familiar with the signal input(s), output(s) and power requirements.

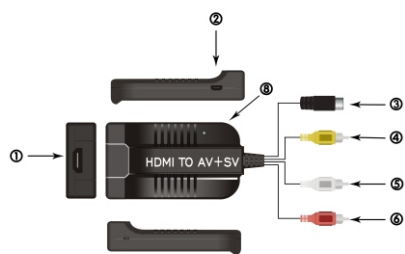

- |                    |                  |
|--------------------|------------------|
| 1: HDMI IN         | 2: USB POWER     |
| 3: S-Video(Female) | 4: CVBS(Male)    |
| 5: Audio L(Male)   | 6: Audio R(Male) |
| 7: Mode Key        | 8: Power Led     |

~ 4 ~

### 5.0 Connection Diagram

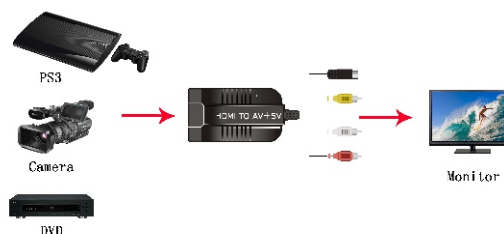

~ 5 ~

~ 6 ~